

Bel Air[®]
PNEUMÁTICA & HIDRÁULICA

[CATÁLOGO]

VÁLVULA POPPET 8.000



VÁLVULA POPPET 1/8"

CARACTERÍSTICAS TÉCNICAS

Pressão	Máxima de 10,5 kgf/cm ² (150 psi)
Temperatura	-10°C a 80°C
Fluído	Ar comprimido filtrado e lubrificado

MATERIAIS

Corpo	Alumínio
Carretel	Zamak Injetado
Vedações	Buna-N



CODIFICAÇÃO

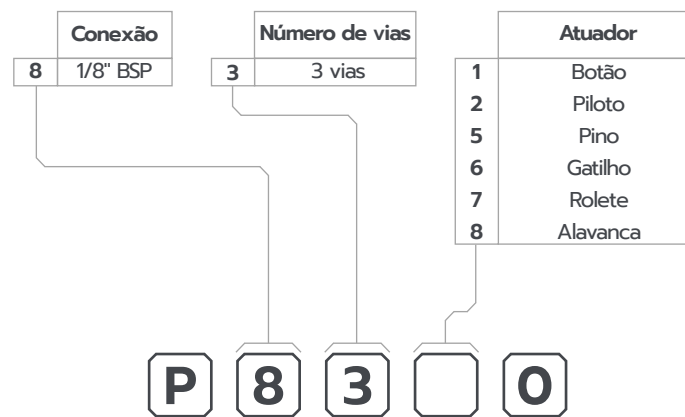

Obs.: Válvula de acionamento leve e retorno por mola.

KIT DE REPARO

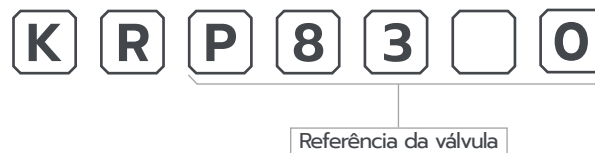

DIMENSIONAL

Botão Mola

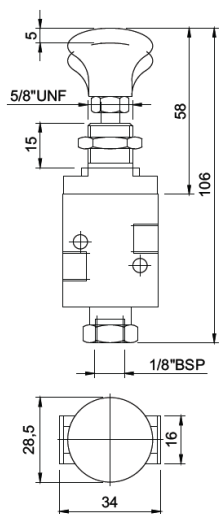

Piloto Mola

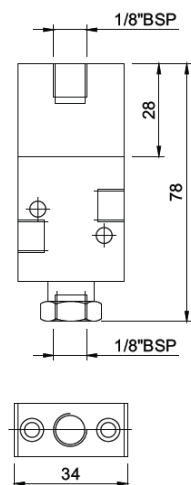

Pino Mola

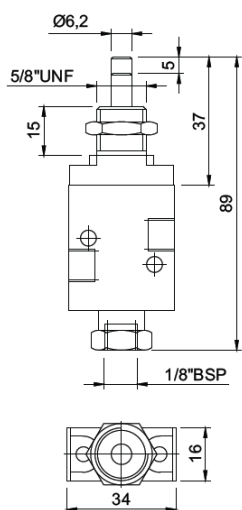

Gatilho Mola

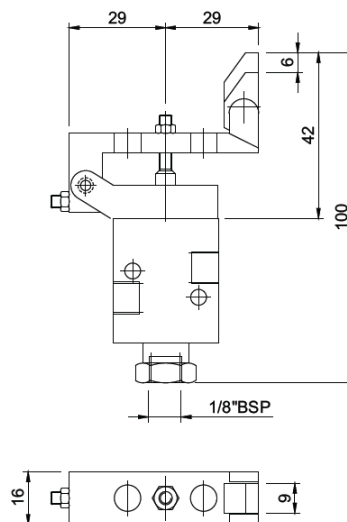

Rolete Mola

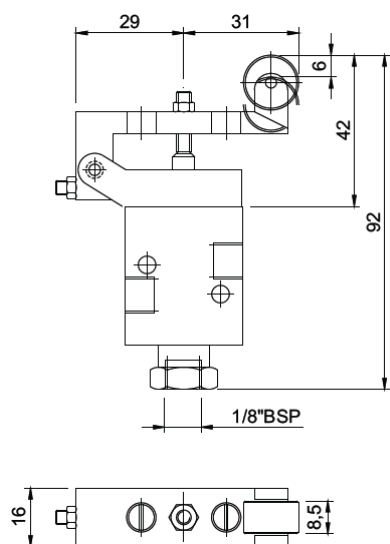

Alavanca Mola

