

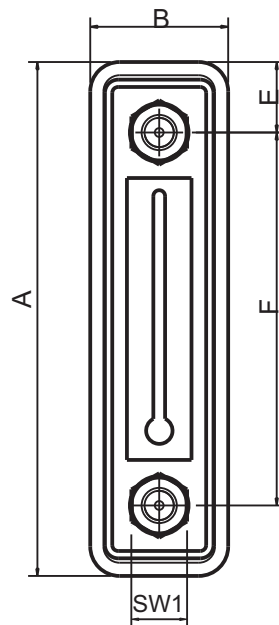

CARACTERÍSTICAS TÉCNICAS:

VEDAÇÕES BORRACHA NITRILICA  
ESCALA TEMPERATURA DUPLA  
30-80°C E 86-176°F  
TORQUE MÁX. MONTAGEM 1,3kgf/m

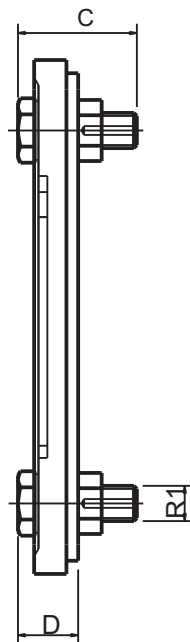

*Dimensões*

REFERÊNCIA	A	B	C	D	E	F	R1	Sw1
VNI127	178	50	38	20	25	127	M12X1.75	19